

CORROSION ISOLATOR



WWW.ISO-GUARD.COM

FEATURES:

-Ribs

Tests indicate ISO-GUARD has more load bearing capacity than other products. Rib structure works in conjunction with adhesive to form solid, unitized base for pipe.

-Durable Materials

Molded from high strength fiber reinforced polymer (FRP). Suitable for applications requiring stiffness and strength. Excellent chemical resistance, low temperature toughness, and UV stable.

EASY INSTALLATION:

For detailed instructions see installation guide.

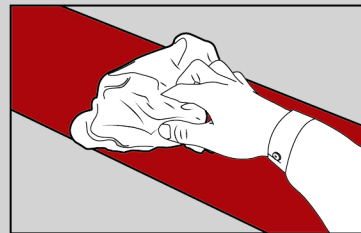

Prepare support surface.

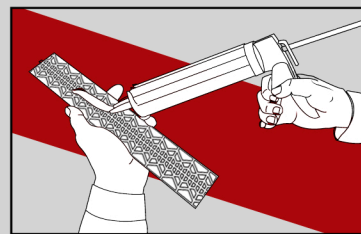

Mark placement of ISO-GUARD™ segment. Apply recommended adhesive to underside of ISO-GUARD™.

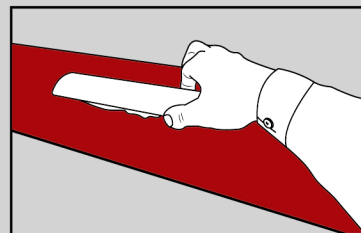

Place ISO-GUARD™ Corrosion Isolator onto prepared substrate. Press down with moderate force for a strong bond.

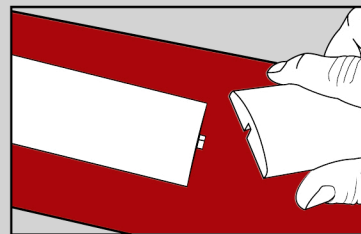

Install segments one at a time using interlocking feature to ensure proper alignment.

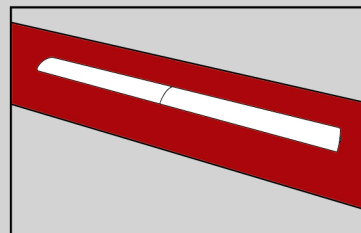

Set pipe on top of installed ISO-GUARD™ Corrosion Isolator.

A product of Noble Plastics Inc.
www.nobleplastics.com
(337) 662-5374